

**Crystel**

# **TITANIUM**™

Rapid-action sterile sporicides for surface  
disinfection in controlled environments



# Rapid-action sterile sporicides for surface disinfection in controlled environments

Based on Tristel's proprietary chlorine dioxide chemistry, Crystel Titanium Wipes and Crystel Titanium Spray are designed specifically for surface disinfection in controlled environments.



**THE ONLY STERILE SPORICIDES THAT TICK ALL THE RIGHT BOXES**

## VERSATILE

Crystel Titanium Wipes and Spray are designed specifically for sporicidal surface disinfection within controlled environments, as recommended by the NHS\*. They can be used on non-product contact surfaces such as workbenches, shelves, equipment, printers and surfaces outside the Laminar Air Flow cabinet (LAF) for sporicidal disinfection and as part of a rotational regime.

## COMPATIBLE

Chlorine dioxide has been tested for compatibility with numerous materials including:

- Stainless Steel (316)
- PEEK
- PVDF
- Fluorocarbon
- Glass
- Polypropylene
- Elastomeric PTFE
- Polyurethane

## EFFECTIVE

Microbiological testing in independent and UKAS-accredited laboratories has confirmed the efficacy of Crystel Titanium against organisms such as *Bacillus subtilis*, *Aspergillus brasiliensis*, *Candida albicans*, *Staphylococcus aureus*, *Staphylococcus haemolyticus*, *Micrococcus luteus* and *Pseudomonas aeruginosa*.

## HIGH QUALITY

Crystel Titanium Wipes are made of a high quality non-woven, low-linting polyester cellulose blend and each measure 23cm x 23cm for excellent surface coverage. Crystel Titanium Spray incorporates a unique and durable trigger mechanism for the application of Tristel's proprietary chlorine dioxide chemistry.

## FAST

Crystel Titanium Wipes and Spray are effective in short contact times. Efficacy is achieved at one consistent concentration and within the natural drying time of the surface.

## INNOVATIVE

Crystel Titanium incorporates two separate compartments that contain Tristel Base (citric acid) and Tristel Activator (sodium chlorite) solutions. When mixed, Tristel's proprietary chlorine dioxide chemistry is generated.

Crystel

**TITANIUM**™

\* 'Guidance for Aseptic Transfer Processes in the NHS: Addressing Sporidical Issues' (July 2015)

## HOW TO USE CRYSTEL TITANIUM WIPES

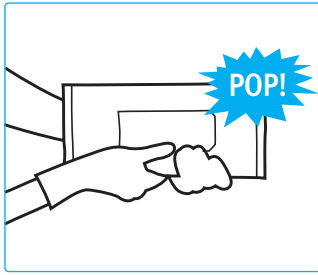

### Step 1

Hold the double-bagged pack horizontally and press to pop the Activator sachet inside the pack using both hands.

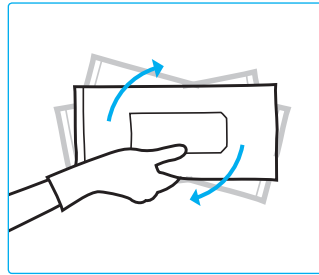

### Step 2

Shake the pack gently for a few seconds to ensure an even dispersal of Activator solution over the wipes.



### Step 3

Leave the wipes to activate for ten minutes prior to use. Then open the pack, remove the empty Activator sachet and reseal the pack. Discard the Activator sachet to waste. Discard the wipes after eight hours even if unused.

## HOW TO USE CRYSTEL TITANIUM SPRAY

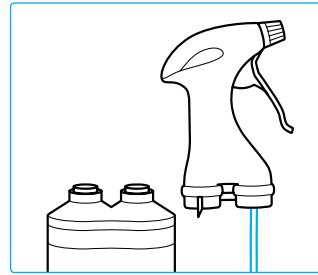

### Step 1

To assemble for use, remove both bottle caps.

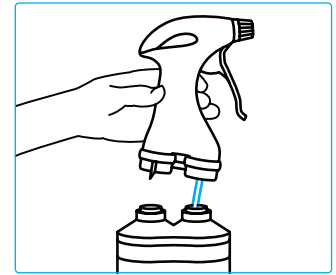

### Step 2

Place the head into the Titanium Spray pack by inserting the tube into the open bottle neck.

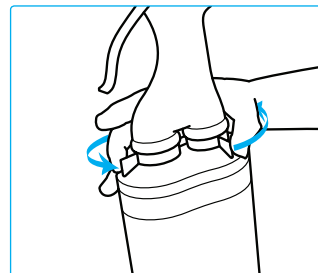

### Step 3

Attach the head to the Titanium Spray pack by fastening the levers on each side.

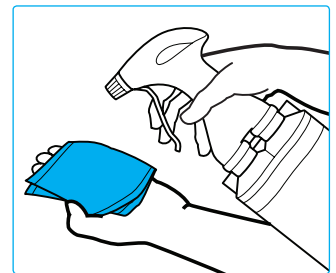

### Step 4

Titanium Spray is now ready to use. It can either be applied directly onto a surface or onto a dry wipe. Then use the wipe to spread the disinfectant over the surface.

# CONTACT TIME



# CONTACT TIME



## PRODUCT OPTIONS

### CRYSTEL TITANIUM WIPES



16 x 20 wipe packs/box

### CRYSTEL TITANIUM SPRAY



**OPTION ONE:** 1 x 600ml bottle/box & 1 x spray head

**OPTION TWO:** 6 x 600ml bottle/box & 6 x spray head

Each Titanium product comes with its own technical file, Certificate of Analysis, Certificates of Sterility and Certificates of Irradiation.

## Tristel™

Created by: Tristel Solutions Limited, Lynx Business Park, Cambs, UK, CB8 7NY  
T +44 (0) 1638 721500 - E mail@tristel.com - W www.tristel.com

For Tristel patent information please visit: <http://www.our-patents.info/tristel>

Copyright © Tristel Solutions  
Mkt-Bro-140-3  
March 2018

**Tristel™**

**WE HAVE CHEMISTRY.**